

Your meeting rooms

Room layouts adapted to your specific meeting requirements

On the first floor of paved courtyard

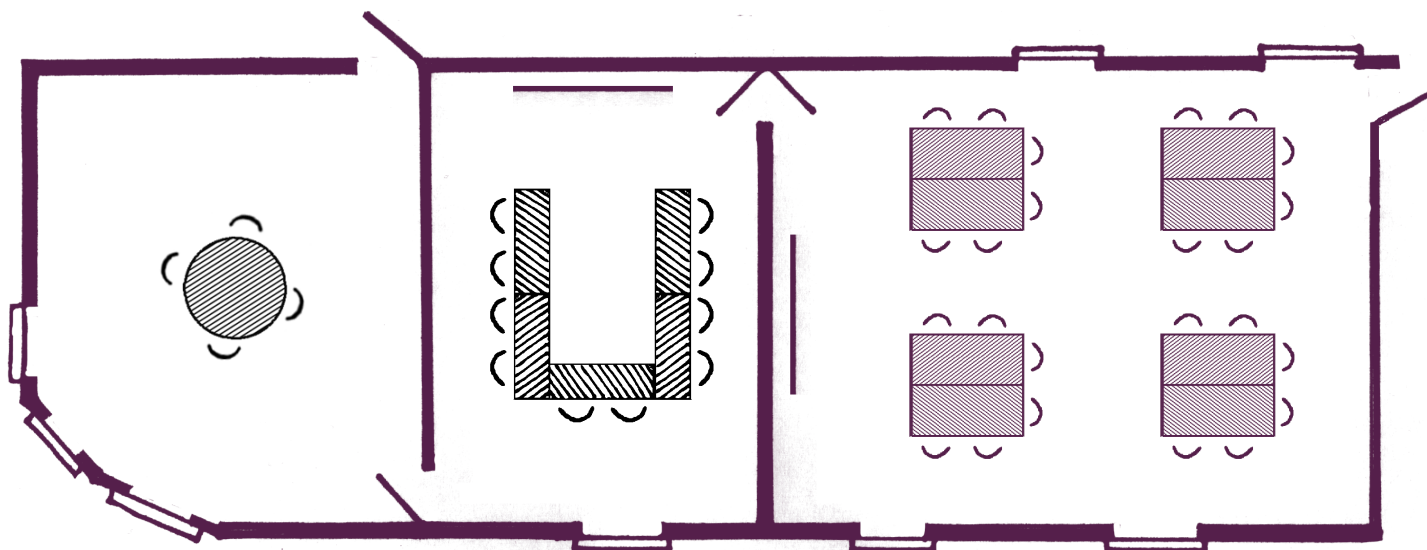

Salle Azalée
4 participants
(25 m², 5 m x 5 m)

Salle Taxus
10 participants
(30 m², 6 m x 5 m)

Salle des Rosiers
24 participants
(54 m², 9 m x 6 m)

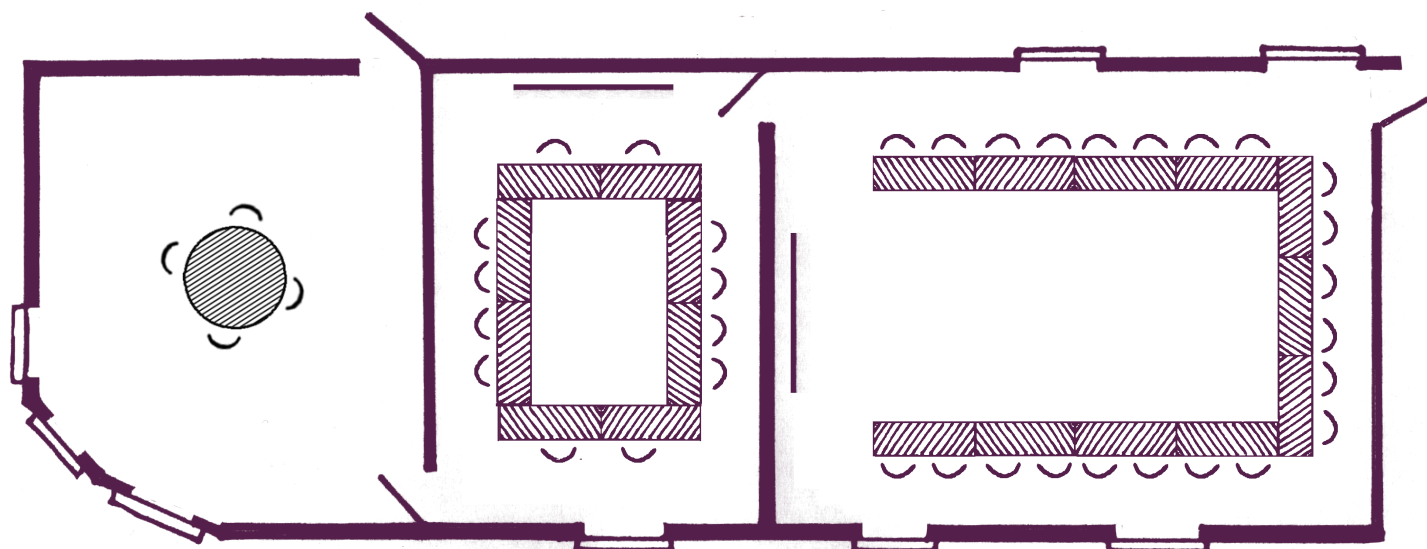

Salle Azalée
4 participants
(25 m², 5 m x 5 m)

Salle Taxus
12 participants
(30 m², 6 m x 5 m)

Salle des Rosiers
22 participants
(54 m², 9 m x 6 m)



The home of seminars
Châteauform'

Château de Neuville-Bosc

Your meeting rooms

Room layouts adapted to your specific meeting requirements

Near the porch... the courtyard of Troène

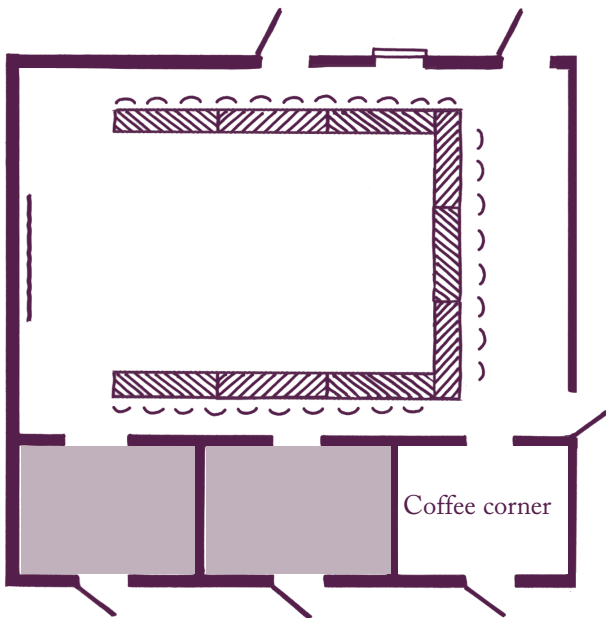

28 participants

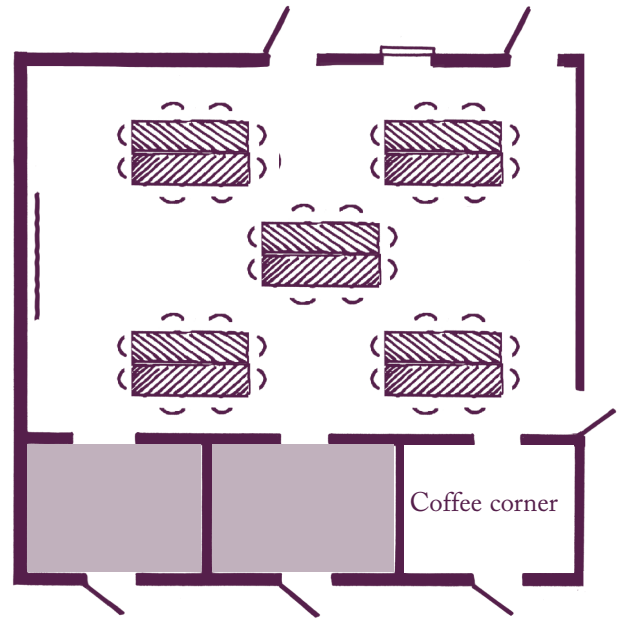

40 participants

Troène

(77 m², 11 m x 7 m)

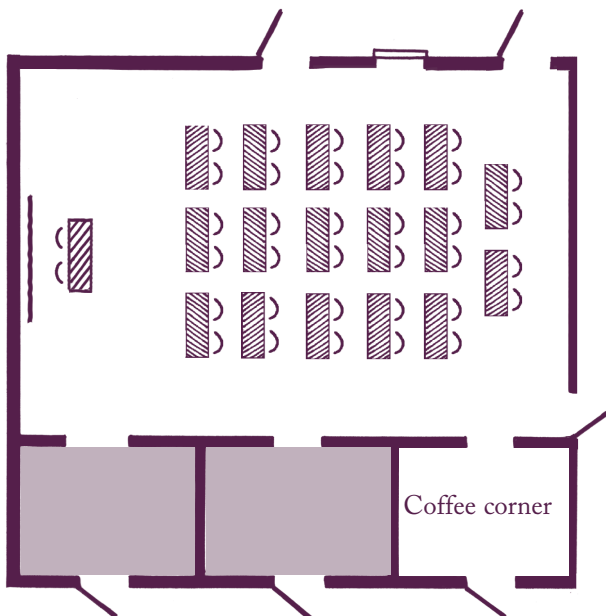

35 participants

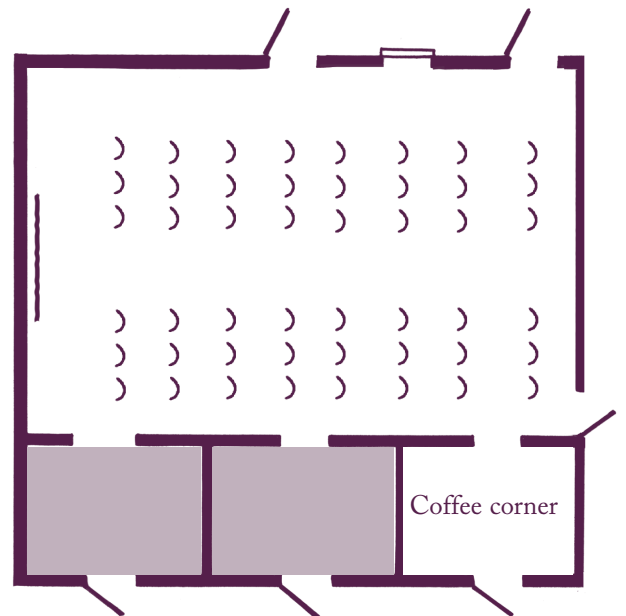

48 participants

Troène

(77 m², 11 m x 7 m)



The home of seminars
Châteauform'

Château de Neuville-Bosc

Your meeting rooms

Room layouts adapted to your specific meeting requirements

In the “Jardins” courtyard

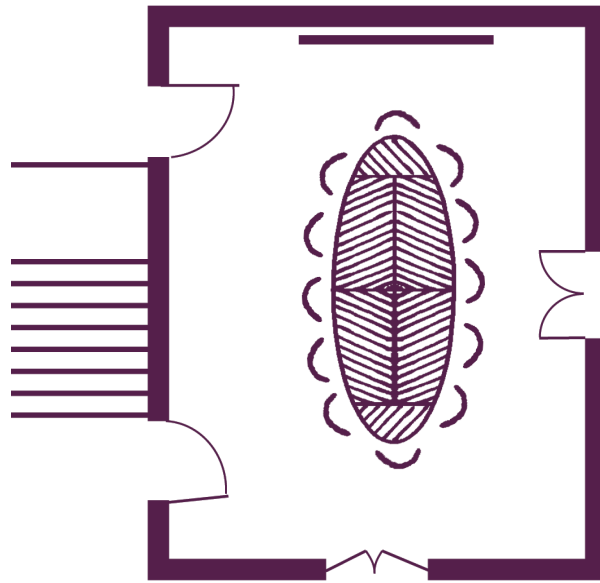

Glycine
12 participants
(30 m²)

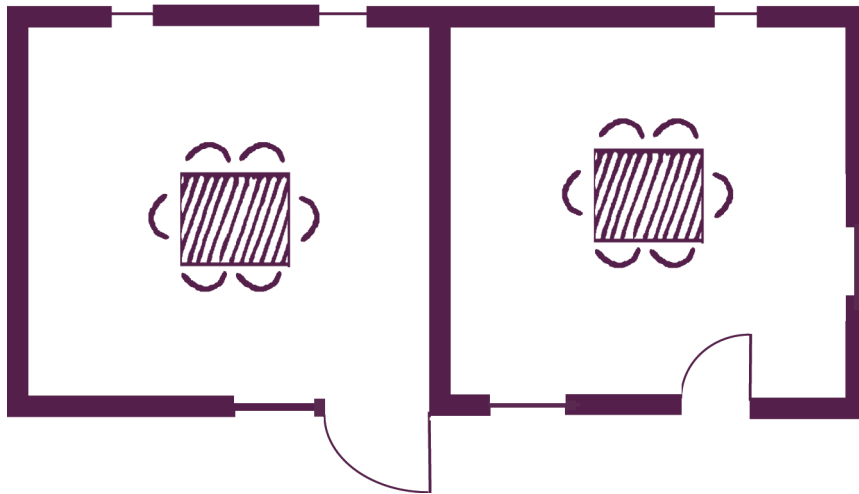

Bois joli
6 participants
(20 m²)

Bruyère
6 participants en conférence
(18 m²)

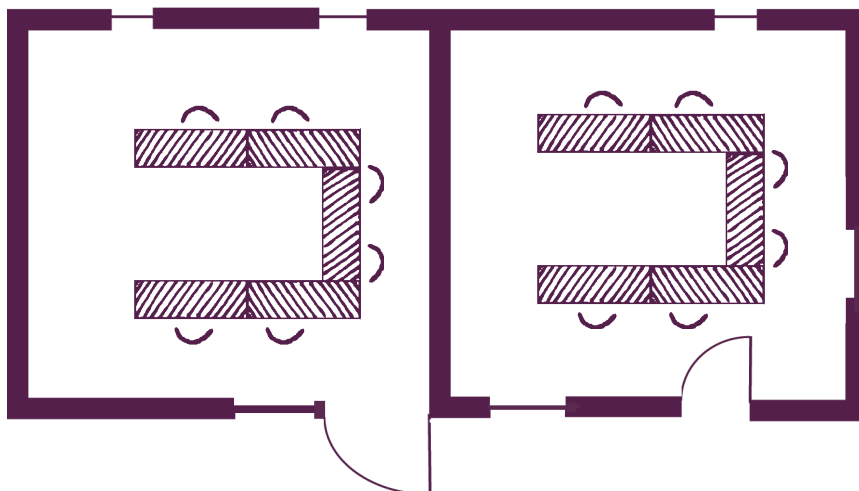

Bois joli
6 participants
(20 m²)

Bruyère
6 participants en U
(18 m²)



The home of seminars
Châteauform'

Château de Neuville-Bosc

Your meeting rooms

Room layouts adapted to your specific meeting requirements

In the “Jardins” courtyard

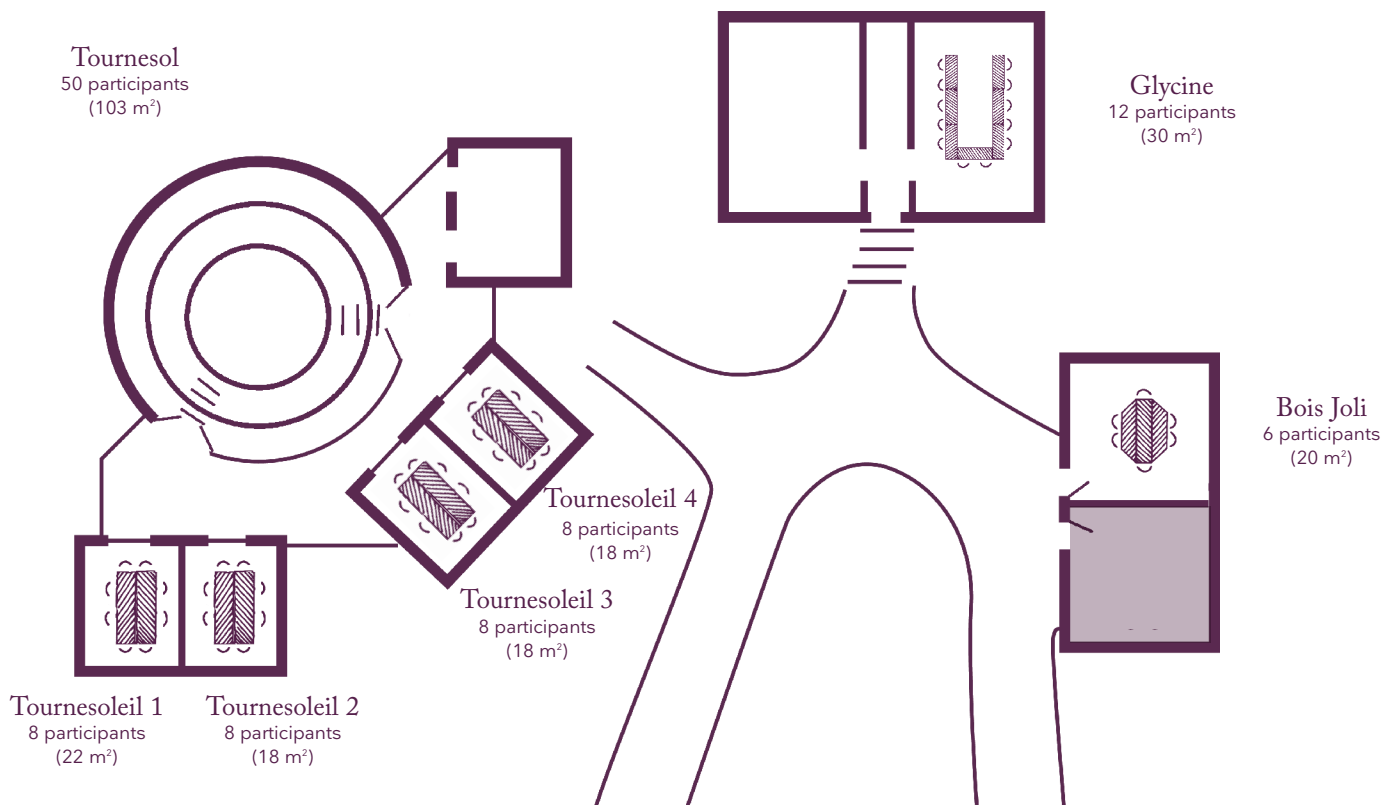

The home of seminars
Châteauform'

Château de Neuville-Bosc