

Your meeting rooms

Room layouts adapted to your specific meeting requirements

On the moat level

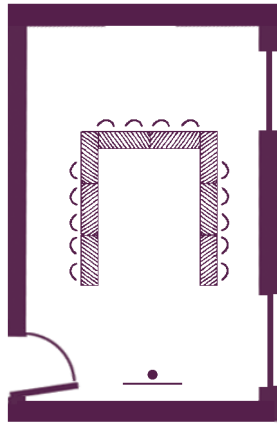

“Gilles Caron”
14 participants
(46 m²; 6,7 m x 6,9 m)

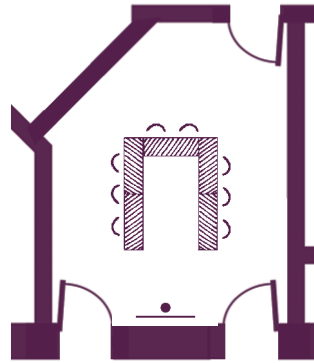

“Richard Avedon”
8 participants
(32 m²)

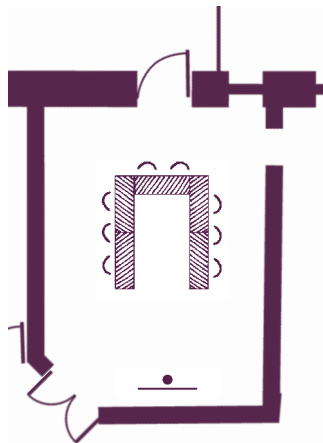

“Sepia”
8 participants
(34 m²; 4,9 m x 7 m)



The home of seminars
Châteauform'

Château de Ronqueux

Your meeting rooms

Room layouts adapted to your specific meeting requirements

On the garden level

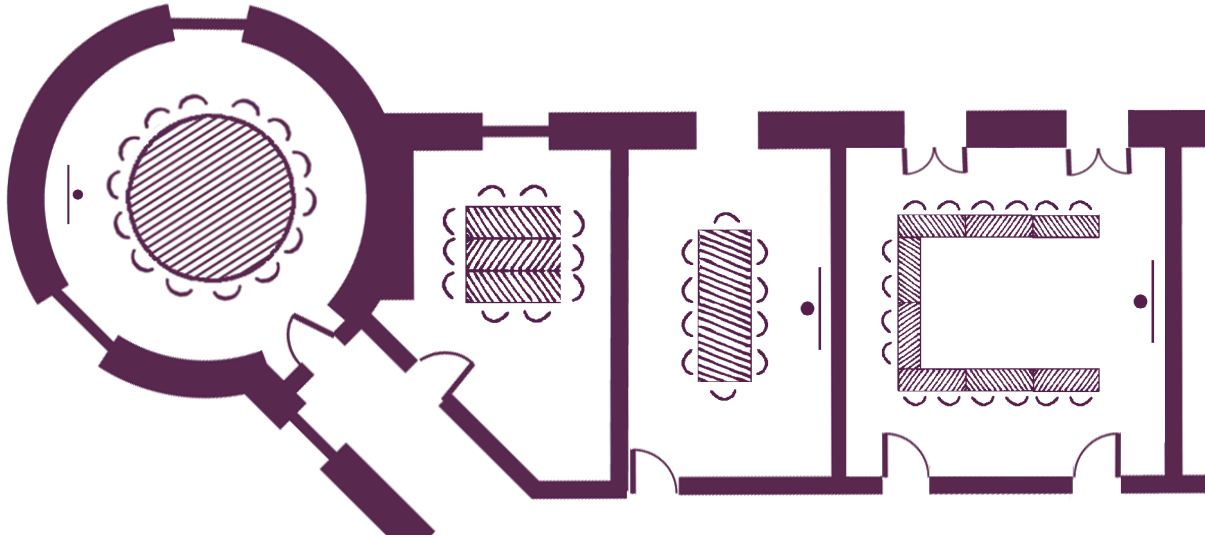

“Helmut Newton”

14 participants
(39,5 m²)

“Mat”

10 participants
(28 m²)

“Brillant”

10 participants
(24 m²)

“Mark Shaw”

16 participants
(49 m²; 7 m x 7 m)

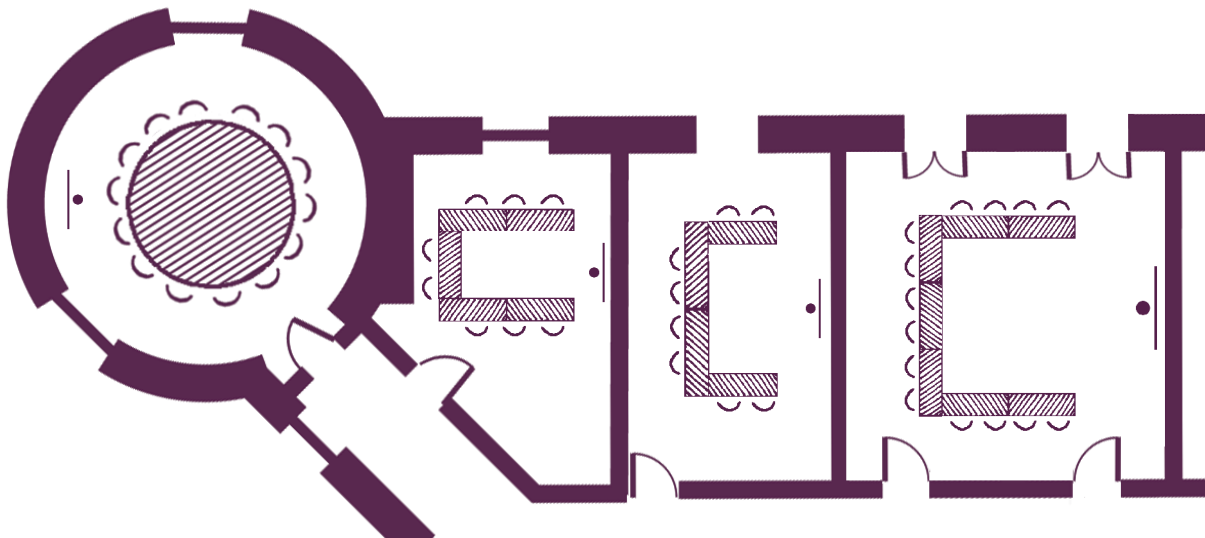

“Helmut Newton”

14 participants
(39,5 m²)

“Mat”

8 participants
(28 m²)

“Brillant”

8 participants
(24 m²)

“Mark Shaw”

14 participants
(49 m²; 7 m x 7 m)



The home of seminars
Châteauform

Château de Ronqueux

Your meeting rooms

Room layouts adapted to your specific meeting requirements

On the garden level

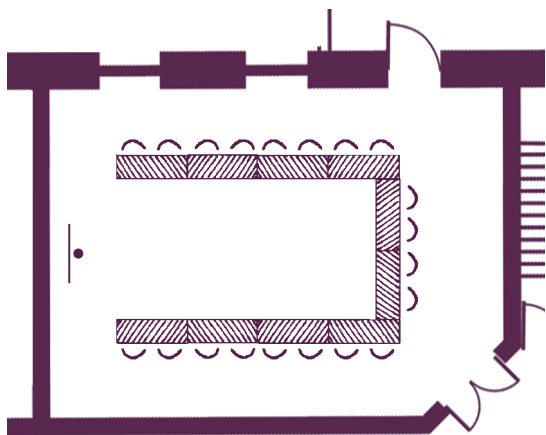

“Sir Cecil Beaton”

20 participants
(68 m²; 9,9 m x 6,9 m)

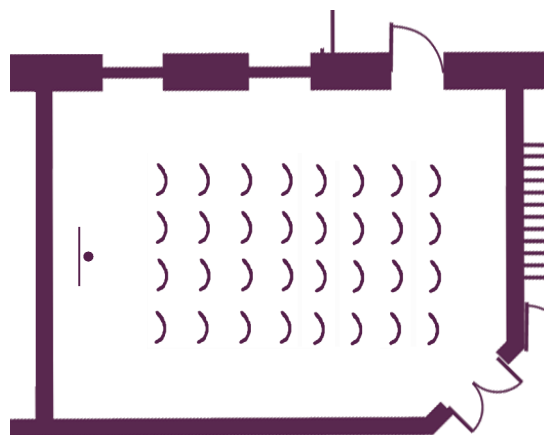

“Sir Cecil Beaton”

32 participants
(68 m²; 9,9 m x 6,9 m)

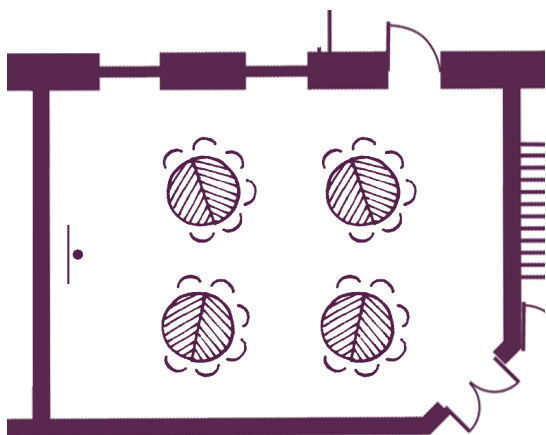

“Sir Cecil Beaton”

24 participants
(68 m²; 9,9 m x 6,9 m)

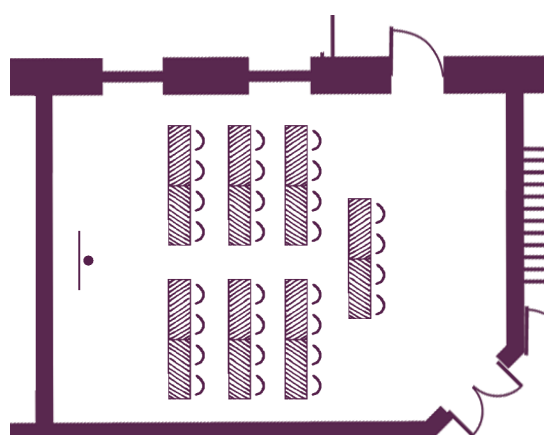

“Sir Cecil Beaton”

28 participants
(68 m²; 9,9 m x 6,9 m)



The home of seminars
Châteauform'

Château de Ronqueux

Your meeting rooms

Room layouts adapted to your specific meeting requirements

Outside

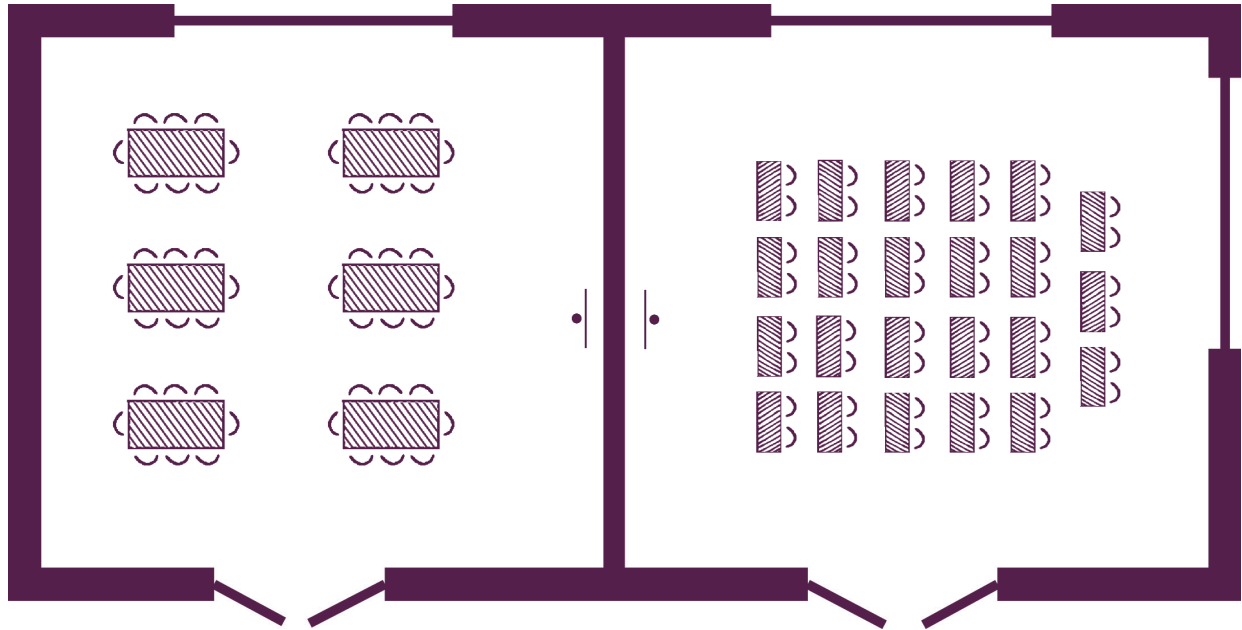

“Robert Capa”

48 participants
(100 m²; 8,6 m x 11,7 m)

“Robert Doisneau”

46 participants
(100 m²; 8,6 m x 11,7 m)



The home of seminars
Châteauform'

Château de Ronqueux